

PURPOSE

ECOPROBE
This drawing is to be used for the purposes of the Council of the City of Romford. It is not to be used for any other purpose without the written permission of the Council.

Notes:
1. This drawing is to be used for the purposes of the Council of the City of Romford. It is not to be used for any other purpose without the written permission of the Council.
2. The Council of the City of Romford is not responsible for any damage or loss arising from the use of this drawing.
3. The Council of the City of Romford is not responsible for any damage or loss arising from the use of this drawing.

NOTES

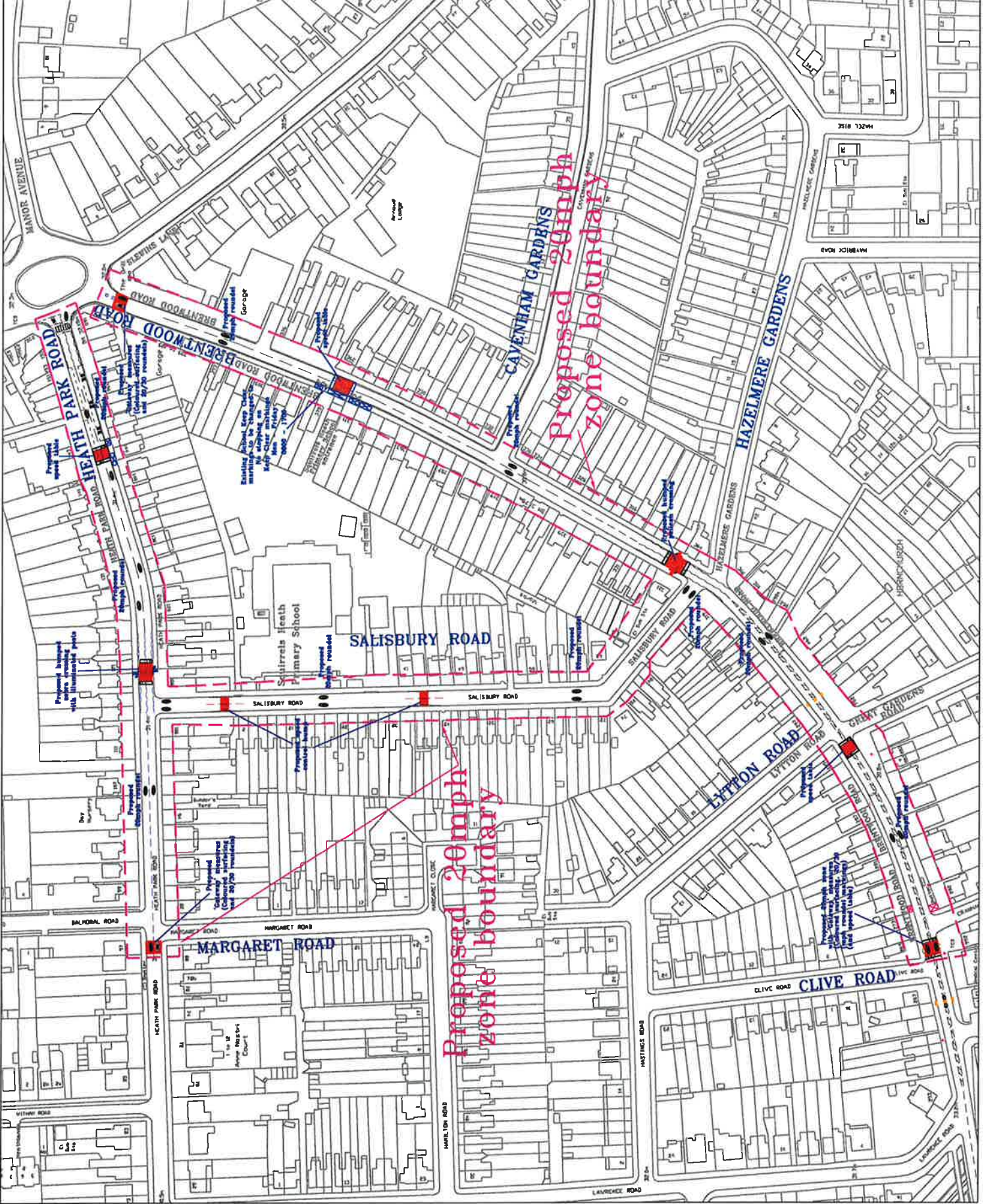

REVISION	AMENDMENT	DATE
JOB TITLE ROMFORD ACCIDENT REDUCTION PROGRAMME		
DRAWING TITLE PROPOSED SAFETY IMPROVEMENTS 20MPH ZONE		
DRAWN BY	CHECKED BY	APPROVED BY
VS	VS	VS
SCALE	DATE	
NTS	SEPT 13	
ACD REF:	DRAWING No.	REVISION
Sheet No. A3 (297/420)	CM001/L	

Havingit
TRAFFIC & ENGINEERING
STREETWISE CULTURE & COMMUNITY
10th Floor Mercury House
Mercury Gardens, Romford
Tel: 01708 437243
Fax: 01708 437241
Email: james@havingit.co.uk

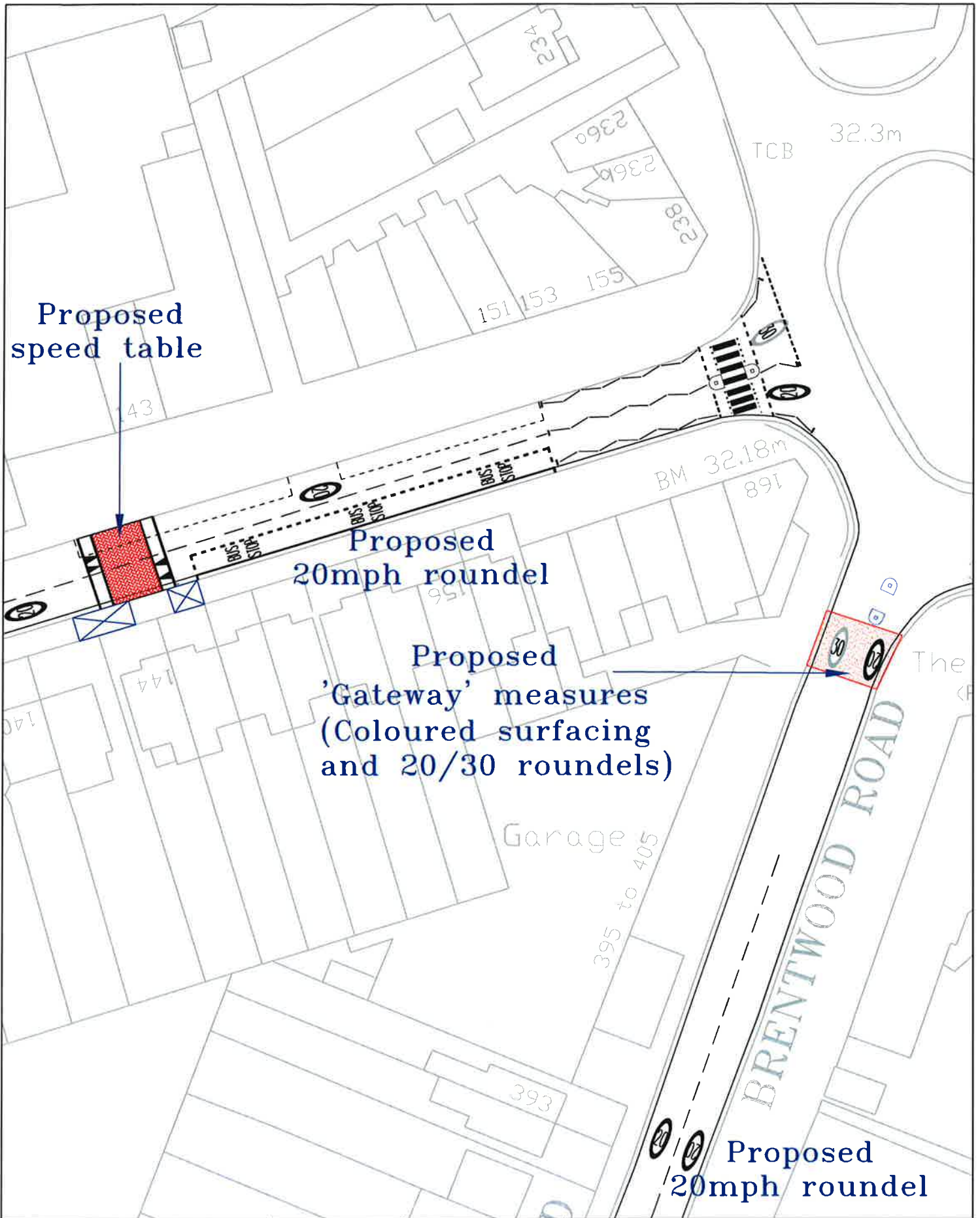

Havering LONDON BOROUGH STREETCARE - CULTURE & COMMUNITY		10th FLOOR MERCURY HOUSE MERCURY GARDENS ROMFORD, RM1 3DH TELEPHONE No: 01708 434343 FAX No: 01708 433721 E-MAIL: streetcare@havering.gov.uk		PURPOSE -			
JOB TITLE ROMFORD ACCIDENT REDUCTION PROGRAMME		©COPYRIGHT This drawing belongs to StreetCore Culture & Community, Traffic & Engineering Section. Neither the whole nor any part thereof may be reproduced without prior written permission.		Based upon Ordnance Survey Mapping with the permission of the Controller of Her Majesty's Stationery Office © Crown copyright. Unauthorised reproduction infringes Crown copyright and may lead to prosecution or civil proceedings. London Borough of Havering 100024327			
DRAWING TITLE PROPOSED SAFETY IMPROVEMENT 20MPH ZONE		DRAWN BY VS	CHECKED BY VS	APPROVED BY VS			
SCALE (AT A4 SIZE) NTS	DATE OCT 13	<input type="checkbox"/> DRAFT <input checked="" type="checkbox"/> ISSUE	ACAD REF: Sheet Size: A4 (210x297)	DRAWING No QM001/1	REVISION -	REVISION -	AMENDMENT -
						DATE	

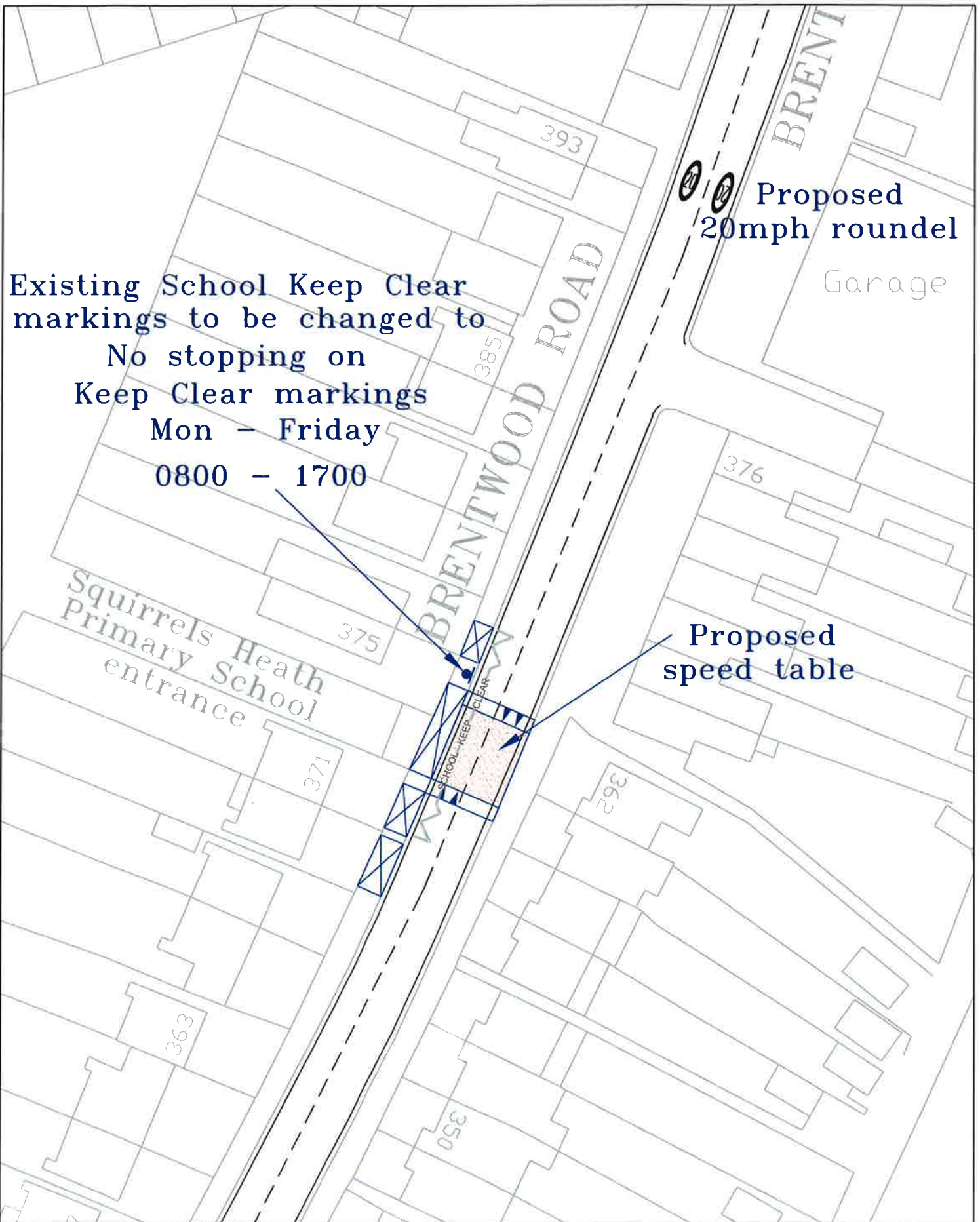

Havering LONDON BOROUGH STREETCARE - CULTURE & COMMUNITY		10th FLOOR MERCURY HOUSE MERCURY GARDENS ROMFORD, RM1 3DW TELEPHONE: No: 01708 434343 FAX: No: 01708 433721 E-MAIL: streetcare@havering.gov.uk		PURPOSE -		©COPYRIGHT This drawing belongs to StreetCare Culture & Community, Traffic & Engineering Section. Neither the whole nor any part thereof may be reproduced without prior written permission.	
JOB TITLE ROMFORD ACCIDENT REDUCTION PROGRAMME		Based upon Ordnance Survey Mapping with the permission of the Controller of Her Majesty's Stationery Office © Crown copyright. Unauthorised reproduction infringes Crown copyright and may lead to prosecution or civil proceedings. London Borough of Havering 100024327		DRAWN BY VS		CHECKED BY VS	
DRAWING TITLE PROPOSED SAFETY IMPROVEMENT 20MPH ZONE		APPROVED BY VS					
SCALE (AT A4 SIZE) NTS	DATE OCT 13	DRAFT <input type="checkbox"/>	ISSUE <input type="checkbox"/>	ACAD REF: Sheet Size: A4 (210x297)	DRAWING No QM001/2/R	REVISION -	AMENDMENT
				REVISION	AMENDMENT	DATE	

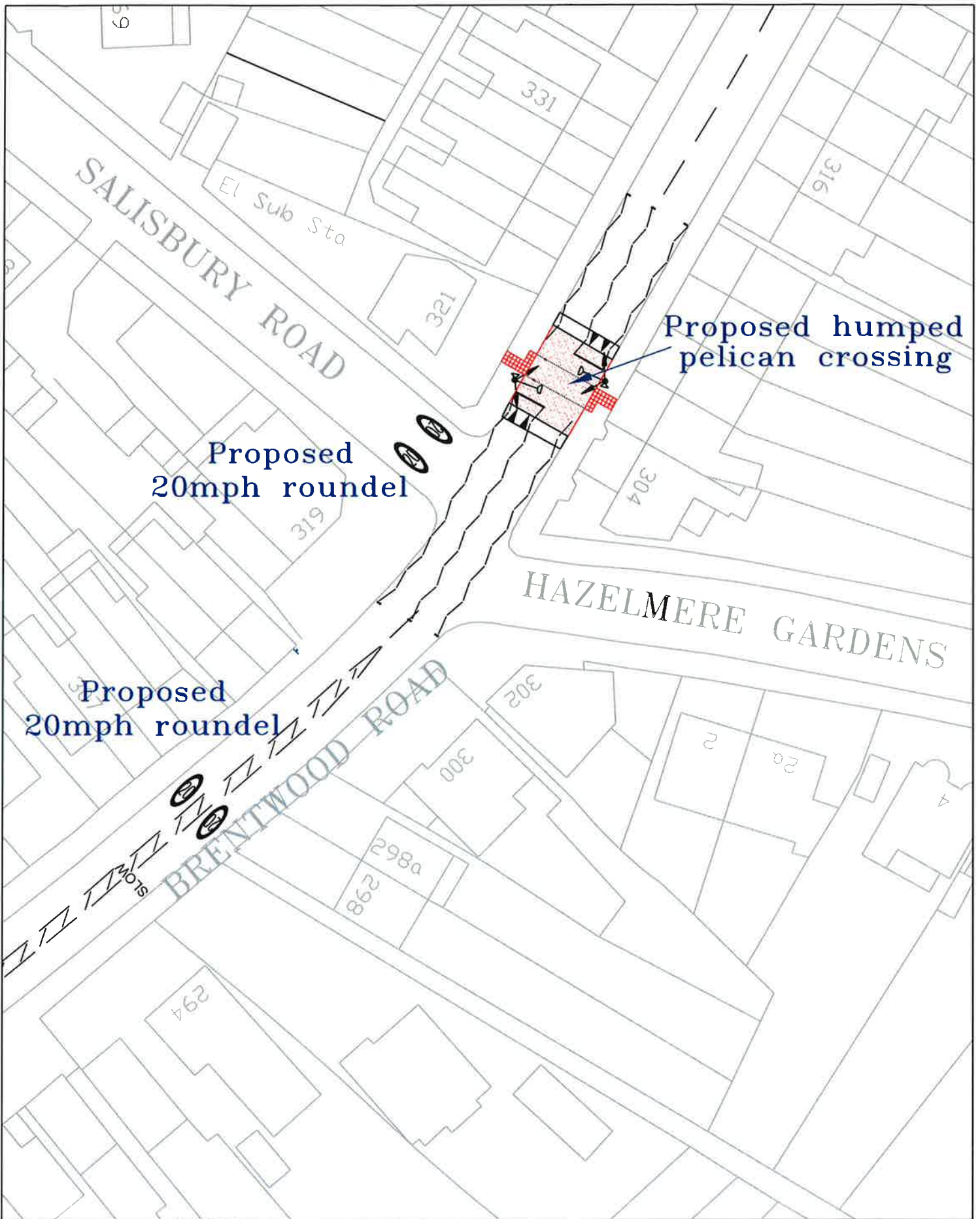

Havering LONDON BOROUGH STREETCARE - CULTURE & COMMUNITY <small>10th FLOOR MERCURY HOUSE MERCURY GARDENS ROMFORD, RM1 3JW TELEPHONE No: 01708 434343 FAX No: 01708 433721 E-MAIL: streetcare@hoving.gov.uk</small>		PURPOSE -			
JOB TITLE ROMFORD ACCIDENT REDUCTION PROGRAMME		©COPYRIGHT This drawing belongs to StreetCare Culture & Community, Traffic & Engineering Section. Neither the whole nor any part thereof may be reproduced without prior written permission.			
DRAWING TITLE PROPOSED SAFETY IMPROVEMENT 20MPH ZONE		Based upon Ordnance Survey Mapping with the permission of the Controller of Her Majesty's Stationery Office © Crown copyright. Unauthorised reproduction infringes Crown copyright and may lead to prosecution or civil proceedings. London Borough of Havering 100024327			
DRAWN BY VS		CHECKED BY VS		APPROVED BY VS	
SCALE (AT A4 SIZE) NTS		DATE OCT 13		REVISION -	
DRAFT		ISSUE		REVISION	
ACAD REF: Sheet Size: A4 (210x297)		DRAWING No QM001/3		AMENDMENT	
				DATE	

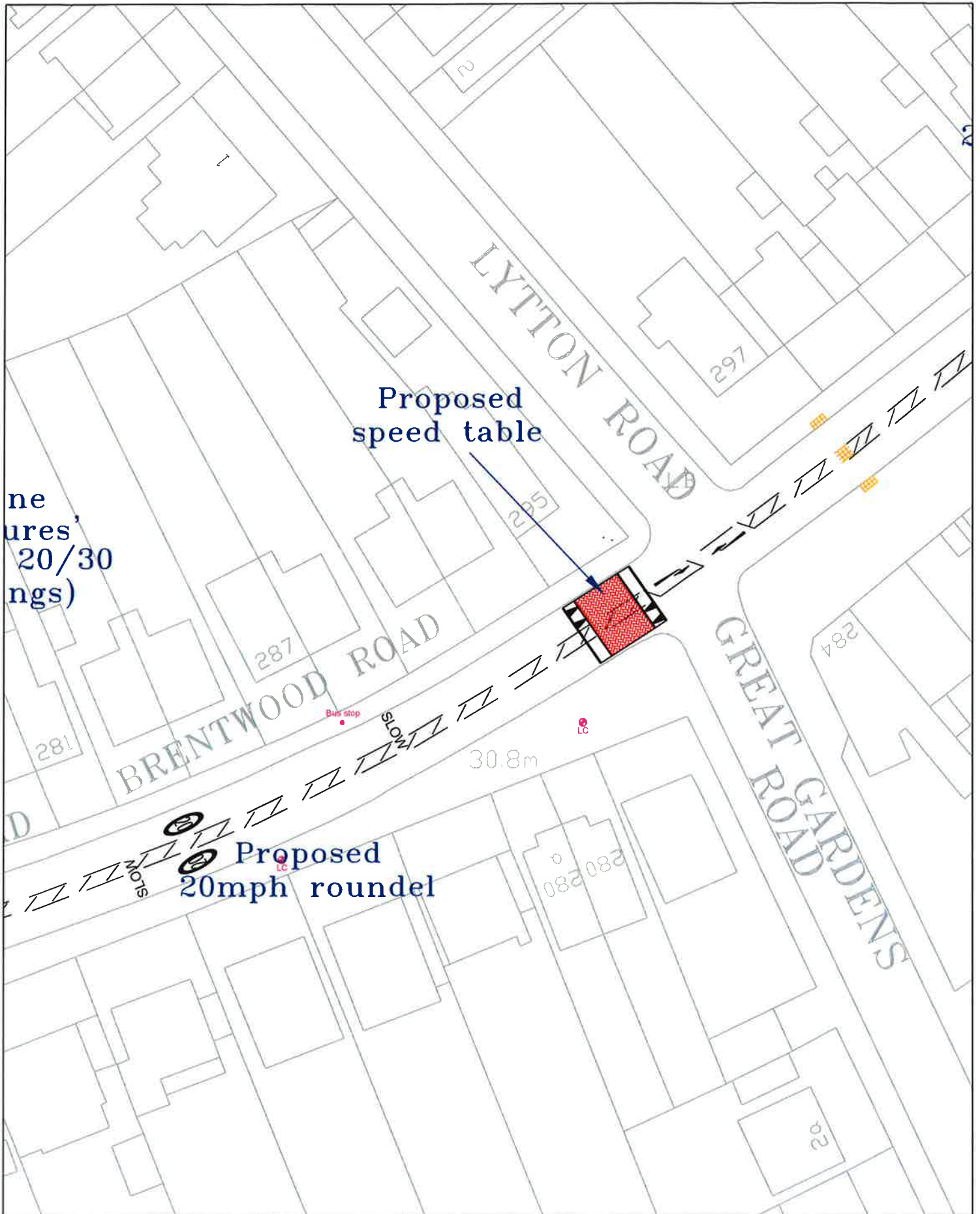

<p>Havering LONDON BOROUGH STREETCARE - CULTURE & COMMUNITY</p>		<p>10th FLOOR MERCURY HOUSE MERCURY GARDENS ROMFORD, RM1 3DH TELEPHONE No: 01708 434343 FAX No: 01708 433721 E-MAIL: streetcare@haverling.gov.uk</p>		<p>PURPOSE -</p>	
<p>JOB TITLE ROMFORD ACCIDENT REDUCTION PROGRAMME</p>		<p>©COPYRIGHT This drawing belongs to StreetCore Culture & Community, Traffic & Engineering Section. Neither the whole nor any part thereof may be reproduced without prior written permission.</p>		<p>Based upon Ordnance Survey Mapping with the permission of the Controller of Her Majesty's Stationery Office © Crown copyright. Unauthorised reproduction infringes Crown copyright and may lead to prosecution or civil proceedings. London Borough of Havering 100024327</p>	
<p>DRAWING TITLE PROPOSED SAFETY IMPROVEMENT 20MPH ZONE</p>		<p>DRAWN BY VS</p>	<p>CHECKED BY VS</p>	<p>APPROVED BY VS</p>	
<p>SCALE (AT A4 SIZE) NTS</p>	<p>DATE OCT 13</p>	<p>■ DRAFT ■ ISSUE</p>	<p>ACAD REF: Sheet Size: A4 (210x297)</p>	<p>DRAWING No QM001/4</p>	<p>REVISION -</p>
				<p>REVISION</p>	<p>AMENDMENT</p>
					<p>DATE</p>

Proposed 20mph zone
with 'Gateway' measures
(Coloured surfacing, 20/30
(mph roundel markings)
(and speed table)

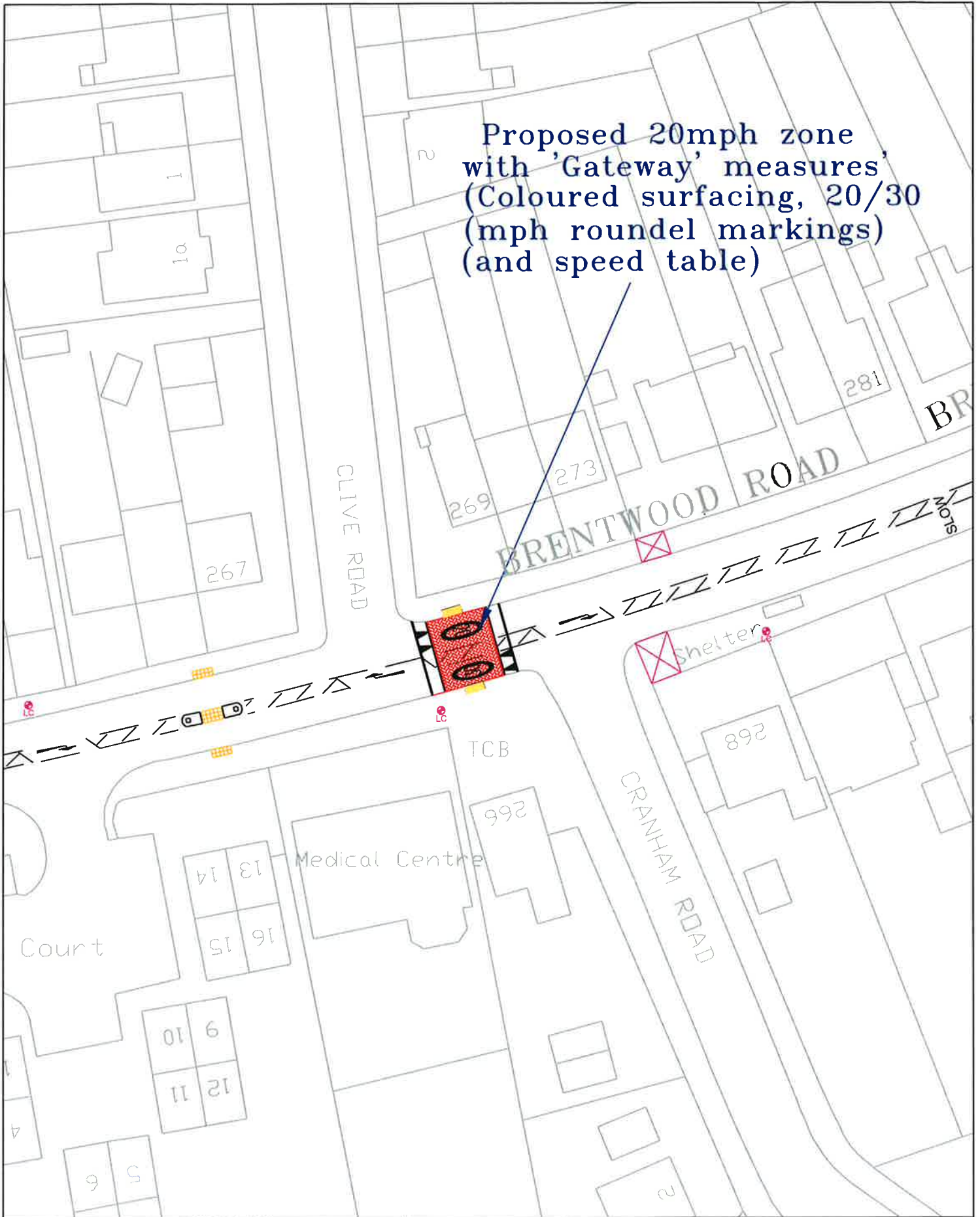

<p>Havering LONDON BOROUGH STREETCARE - CULTURE & COMMUNITY</p>		<p>10th FLOOR MERCURY HOUSE MERCURY GARDENS ROMFORD, RM1 3NH TELEPHONE No: 01708 434343 Fax No: 01708 433721 E-MAIL: streetcare@havering.gov.uk</p>		<p>PURPOSE -</p>	
<p>JOB TITLE ROMFORD ACCIDENT REDUCTION PROGRAMME</p>		<p>©COPYRIGHT This drawing belongs to StreetCore Culture & Community, Traffic & Engineering Section. Neither the whole nor any part thereof may be reproduced without prior written permission.</p>			
<p>DRAWING TITLE PROPOSED SAFETY IMPROVEMENT 20MPH ZONE</p>		<p>Based upon Ordnance Survey Mapping with the permission of the Controller of Her Majesty's Stationery Office © Crown copyright. Unauthorised reproduction infringes Crown copyright and may lead to prosecution or civil proceedings. London Borough of Havering 100024327</p>			
<p>SCALE (AT A4 SIZE) NTS</p>		<p>DATE OCT 13</p>		<p>DRAFT ISSUE</p>	
<p>ACAD REF:</p>		<p>DRAWING No QM001/5</p>		<p>APPROVED BY VS</p>	
<p>REVISION</p>		<p>AMENDMENT</p>		<p>DATE</p>	

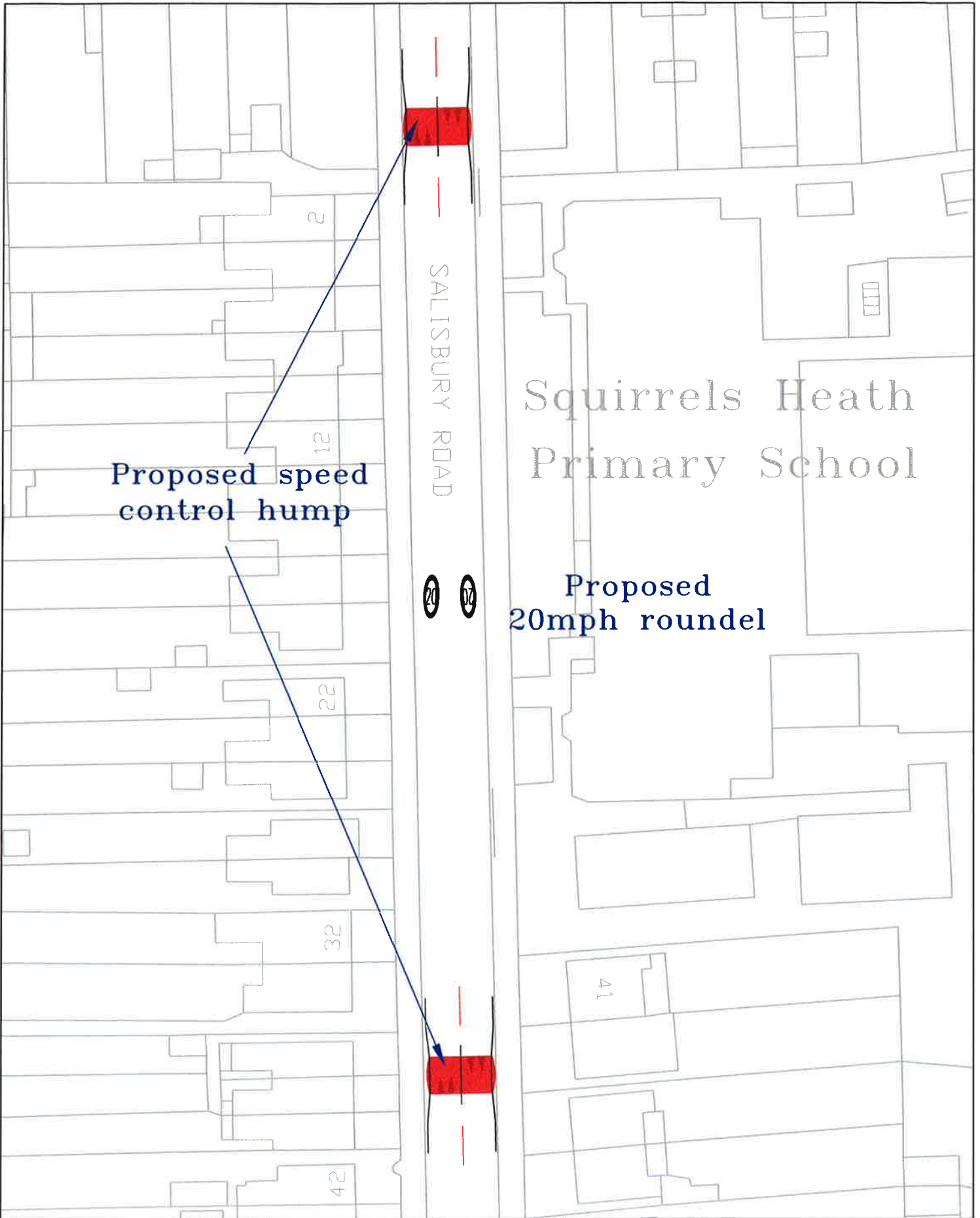

Havering LONDON BOROUGH STREETCARE - CULTURE & COMMUNITY		10th FLOOR MERCURY HOUSE MERCURY GARDENS ROMFORD, RM1 3JH TELEPHONE No: 01708 436343 FAX No: 01708 433721 E-MAIL: streetcare@havering.gov.uk		PURPOSE -				
JOB TITLE ROMFORD ACCIDENT REDUCTION PROGRAMME		©COPYRIGHT This drawing belongs to StreetCore Culture & Community, Traffic & Engineering Section. Neither the whole nor any part thereof may be reproduced without prior written permission.		Based upon Ordnance Survey Mapping with the permission of the Controller of Her Majesty's Stationery Office © Crown copyright. Unauthorised reproduction infringes Crown copyright and may lead to prosecution or civil proceedings. London Borough of Havering 100024327				
DRAWING TITLE PROPOSED SAFETY IMPROVEMENT 20MPH ZONE		DRAWN BY VS	CHECKED BY VS	APPROVED BY VS				
SCALE (AT A4 SIZE) NTS	DATE OCT 13	<input type="checkbox"/> DRAFT <input checked="" type="checkbox"/> ISSUE	ACAD REF: Sheet Size: A4 (210x297)	DRAWING No QM001/6	REVISION -	REVISION	AMENDMENT	DATE

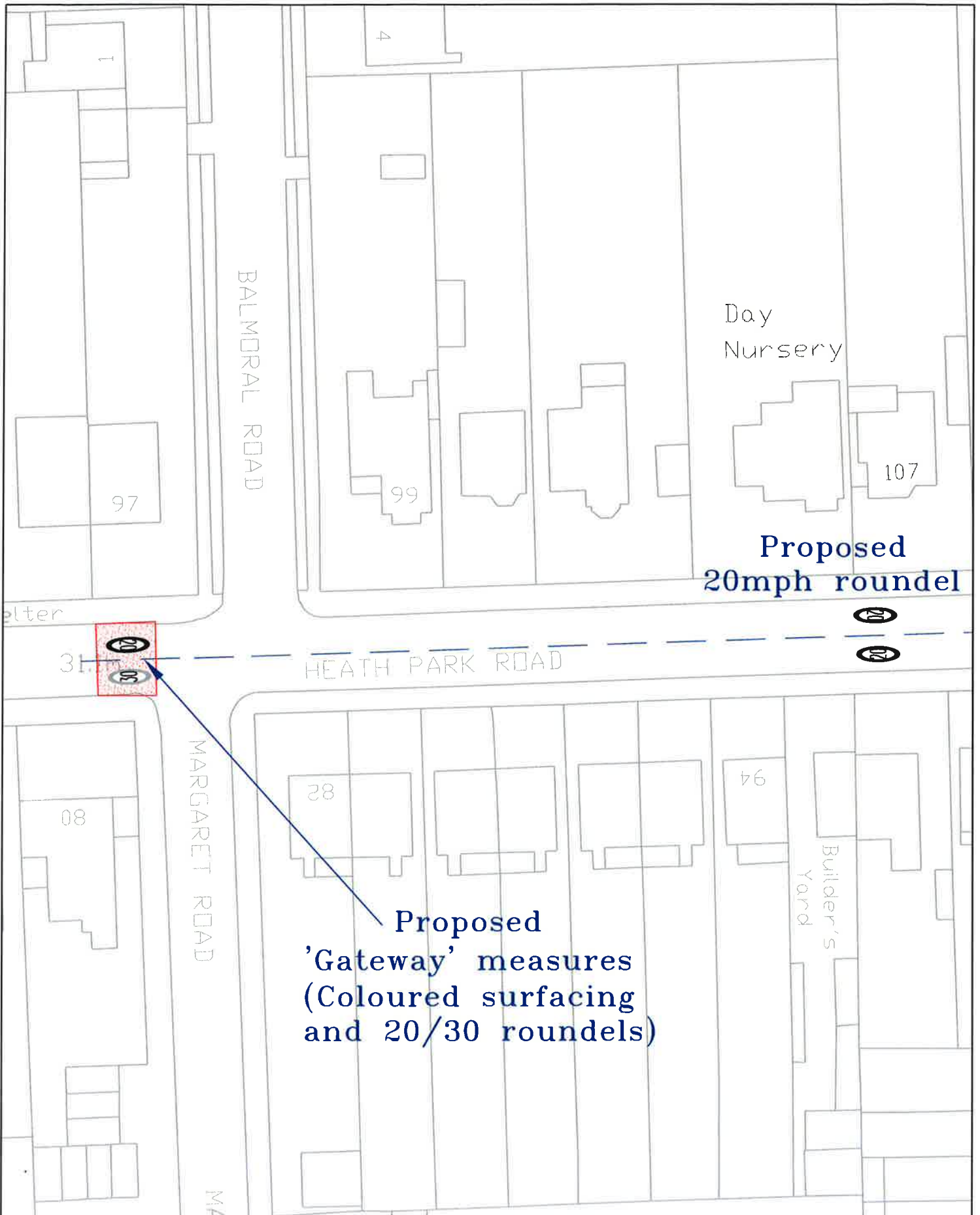

		10th FLOOR MERCURY HOUSE MERCURY GARDENS ROMFORD, RM1 3DW TELEPHONE No: 01708 434343 FAX No: 01708 433721 E-MAIL: streetcare@havering.gov.uk		PURPOSE -		©COPYRIGHT This drawing belongs to StreetCore Culture & Community, Traffic & Engineering Section. Neither the whole nor any part thereof may be reproduced without prior written permission.	
JOB TITLE ROMFORD ACCIDENT REDUCTION PROGRAMME		Based upon Ordnance Survey Mapping with the permission of the Controller of Her Majesty's Stationery Office © Crown copyright. Unauthorised reproduction infringes Crown copyright and may lead to prosecution or civil proceedings. London Borough of Havering 100024327		DRAWN BY VS		CHECKED BY VS	
DRAWING TITLE PROPOSED SAFETY IMPROVEMENT 20MPH ZONE		APPROVED BY VS		REVISION -		AMENDMENT -	
SCALE (AT A4 SIZE) NTS	DATE OCT 13	<input type="checkbox"/> DRAFT <input checked="" type="checkbox"/> ISSUE	ACAD REF: Sheet Size: A4 (210x297)	DRAWING No QM001/7	REVISION -	AMENDMENT -	DATE -

Proposed humped
zebra crossing
with illuminated posts

Proposed
20mph roundel

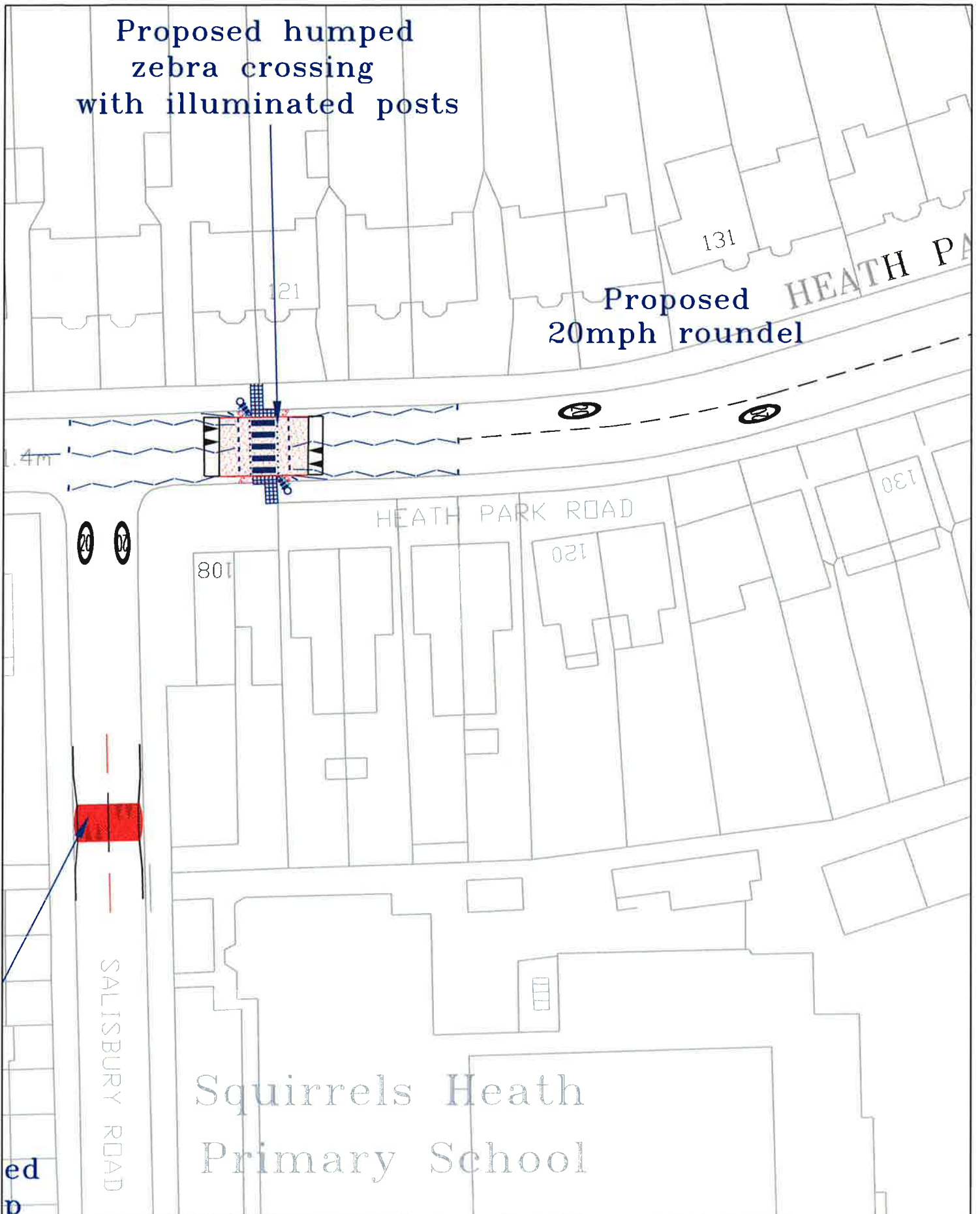

<p>Havering LONDON BOROUGH STREETCARE - CULTURE & COMMUNITY</p>		<p>10th FLOOR MERCURY HOUSE MERCURY GARDENS ROMFORD, RM1 3JW TELEPHONE No: 01708 434343 FAX No: 01708 433721 E-MAIL: streetcare@havering.gov.uk</p>		<p>PURPOSE -</p>	
<p>JOB TITLE ROMFORD ACCIDENT REDUCTION PROGRAMME</p>		<p>©COPYRIGHT This drawing belongs to StreetCare Culture & Community, Traffic & Engineering Section. Neither the whole nor any part thereof may be reproduced without prior written permission.</p>		<p>Based upon Ordnance Survey Mapping with the permission of the Controller of Her Majesty's Stationery Office © Crown copyright. Unauthorised reproduction infringes Crown copyright and may lead to prosecution or civil proceedings. London Borough of Havering 100024327</p>	
<p>DRAWING TITLE PROPOSED SAFETY IMPROVEMENT 20MPH ZONE</p>		<p>DRAWN BY VS</p>	<p>CHECKED BY VS</p>	<p>APPROVED BY VS</p>	
<p>SCALE (AT A4 SIZE) NTS</p>	<p>DATE OCT 13</p>	<p>DRAFT ISSUE</p>	<p>ACAD REF:</p>	<p>DRAWING No QM001/8</p>	<p>REVISION -</p>
			<p>Sheet Size: A4 (210x297)</p>	<p>REVISION</p>	<p>AMENDMENT</p>
					<p>DATE</p>